

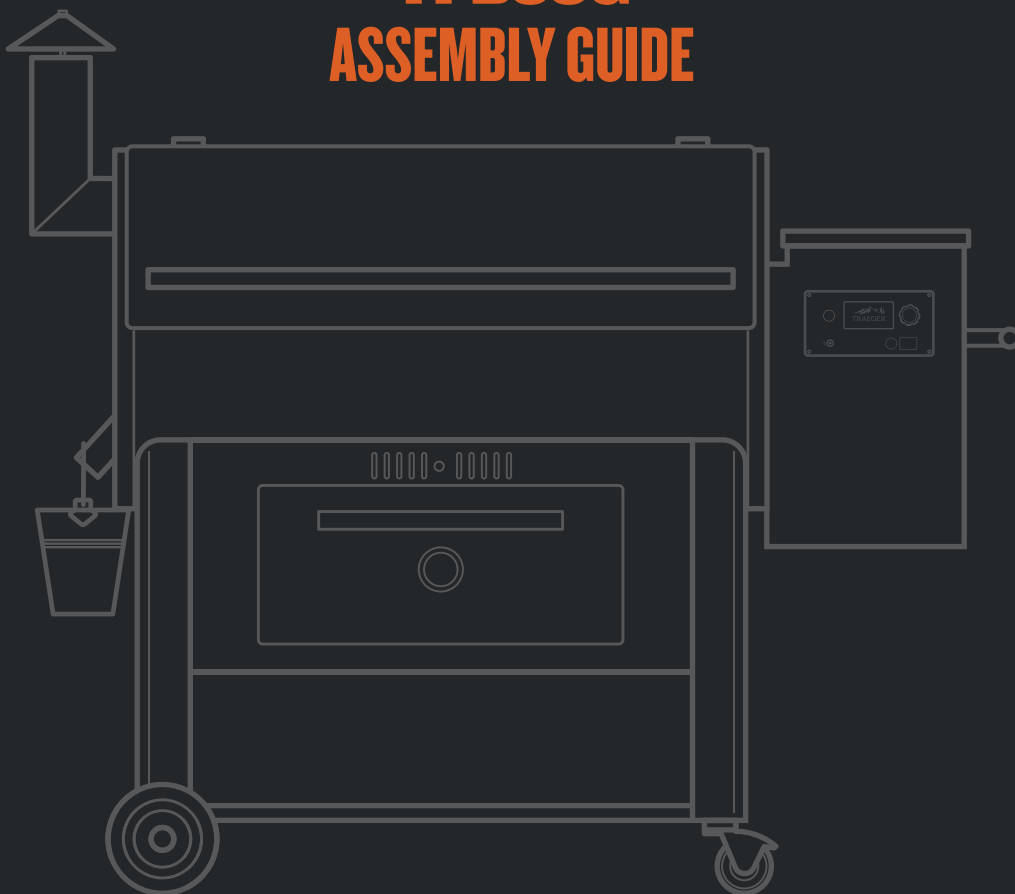

CENTURY 885 D2[®]

— TFB88G — ASSEMBLY GUIDE



IMPORTANT, RETAIN FOR FUTURE REFERENCE: READ CAREFULLY

Please read this entire manual before installation and use of this pellet fuel-burning appliance. Failure to follow these instructions could result in property damage, bodily injury, or even death. Contact your local building or fire officials about restrictions and installation inspection requirements in your area.

A MAJOR CAUSE OF FIRES IS FAILURE TO MAINTAIN REQUIRED CLEARANCES (AIR SPACES) BETWEEN COMBUSTIBLE MATERIALS. IT IS OF UTMOST IMPORTANCE THAT THIS PRODUCT BE INSTALLED ONLY IN ACCORDANCE WITH THESE INSTRUCTIONS. SAVE THESE INSTRUCTIONS.

WARNING!

MANY PARTS OF THE GRILL WILL BECOME VERY HOT DURING OPERATION. CARE MUST BE TAKEN TO AVOID BURNS, BOTH DURING OPERATION AND AFTERWARDS, WHILE THE GRILL IS STILL HOT.

Never leave the grill unattended when young children are present.

Never move the grill when it is operating.

Let the grill cool completely before moving or attempting to transport.

TFB88GLF
TO1091

TRAEEGER PELLET GRILLS LLC
1215 E. WILMINGTON AVE
SALT LAKE CITY, UT 84106

TRAEEGERGRILLS.COM

PARTS LIST

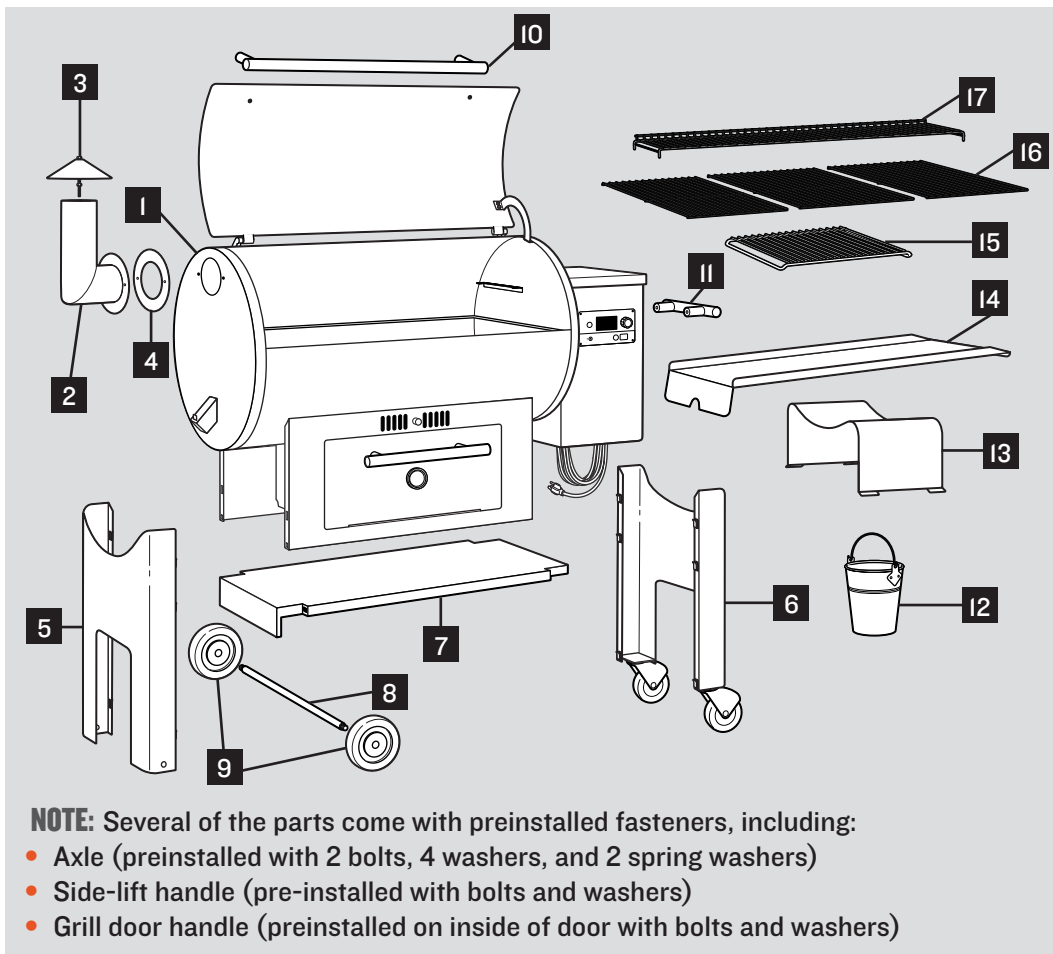

BLISTER PACK PARTS NEEDED

- A** Bolts: 1/4"-20x0.6" (10 pcs)
 - B** Spring Washers: 1/4" (8 pcs)
 - C** Washers: 1/4" (8 pcs)
 - D** Washers: 1/4" (4 pcs)
 - E** Hex Nuts: 1/4"-20 (2 pcs)
- Wrench (2 pcs)

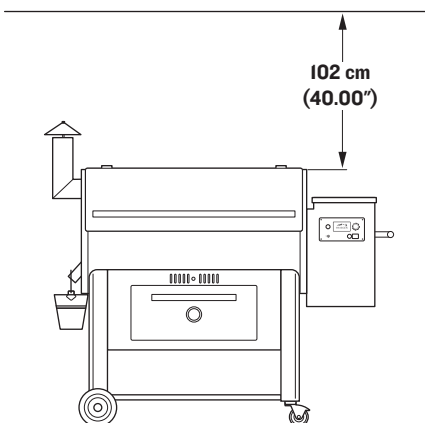

WARNING!

- When operating this grill under overhead combustibles, a **MINIMUM** of 102 cm (40 inches) is required.
- When operating this grill, maintain a **MINIMUM** distance of 45.7 cm (18 inches) from the grill to combustibles.

IMPORTANT!

- The grill is very heavy. Always lift the grill with **TWO** people.

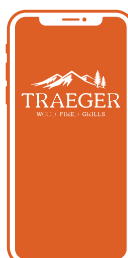
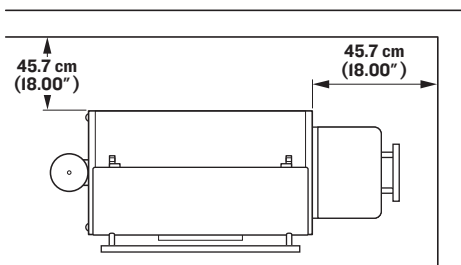

UNLOCK THE FULL POWER OF YOUR GRILL WITH THE TRAEGER APP

ASSEMBLY INSTRUCTIONS, INITIAL FIRING TIPS, FAQs, PLUS USE AND CARE INFORMATION ARE ALL AVAILABLE THROUGH THE APP.

DOWNLOAD THE TRAEGER APP OR GO TO WWW.TRAEGERGRILLS.COM/APP TO LEARN MORE

READ ALL INSTRUCTIONS BEFORE INSTALLING AND USING THE GRILL

Traeger'ing is more fun with friends! (No, really, you will need two people to lift the grill.)

1 UNPACK COMPONENTS AND FLIP OVER GRILL

NOTE: The lower shelf **7** is taped to the inside of the upper box, but may slide inside the lower box during shipping.

NOTE: Grill is secured in box with multiple cardboard pieces, some of which hold grill parts. Be sure to check ALL packaging for parts as you unpack them.

THIS WILL REQUIRE TWO PEOPLE.

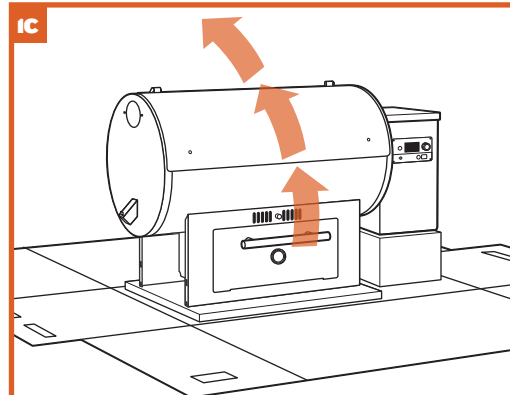
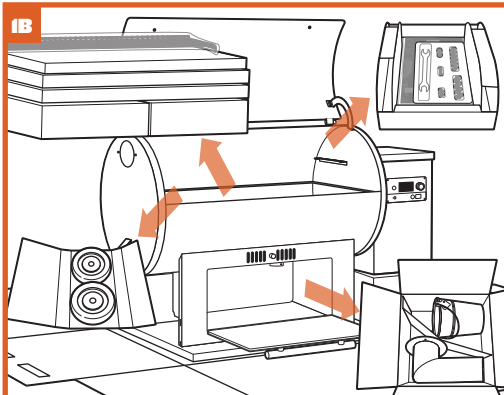
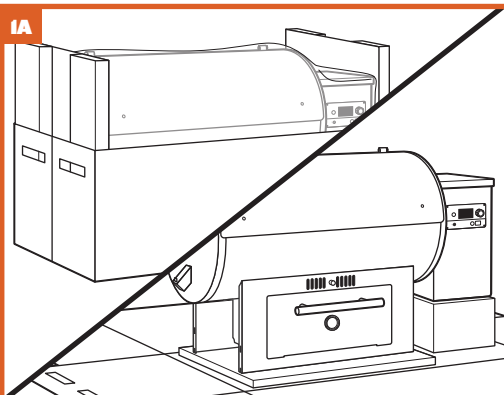

2 INSTALL LEGS

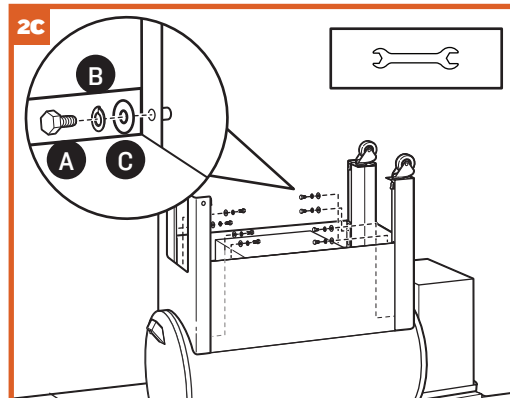
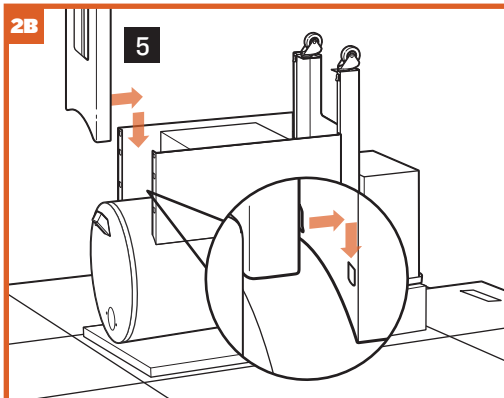
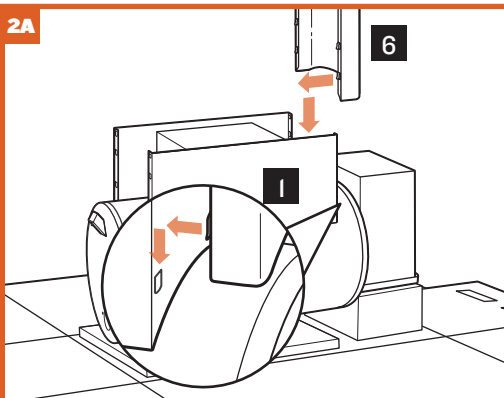

NOTE: Legs have a clip feature that matches up with corresponding slots on the grill body. Do not fully tighten leg bolts at this time.

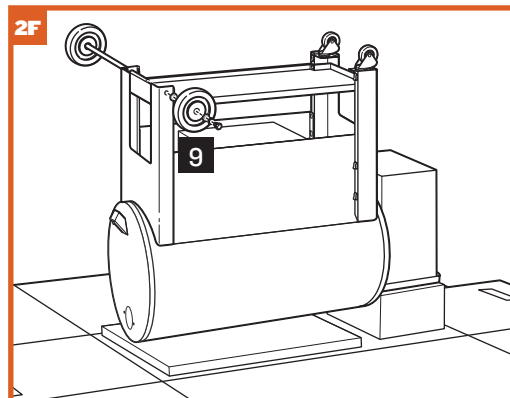
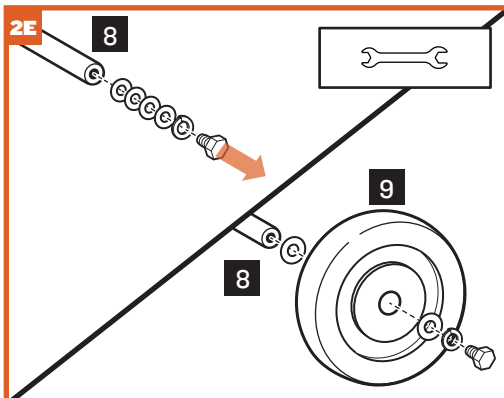
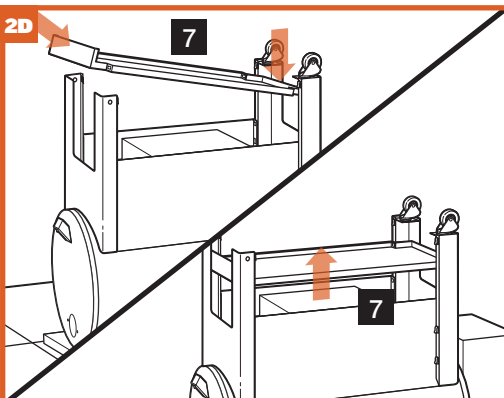

NOTE: After the bottom shelf is installed, fully tighten all leg bolts (Step 2C).

NOTE: Fasteners are preinstalled on the axle.

3 ASSEMBLE UPPER GRILL COMPONENTS

THIS WILL REQUIRE TWO PEOPLE.

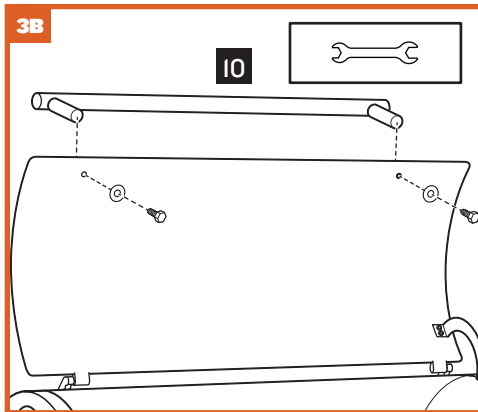
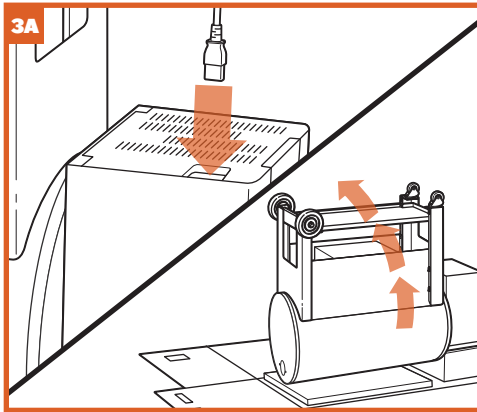

NOTE: Fasteners for lid handle are preinstalled on handle.

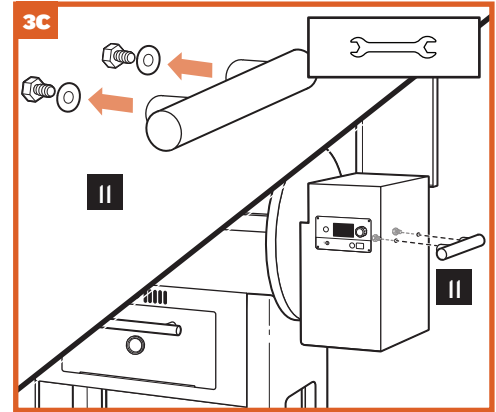

NOTE: Fasteners for side handle are preinstalled on handle.

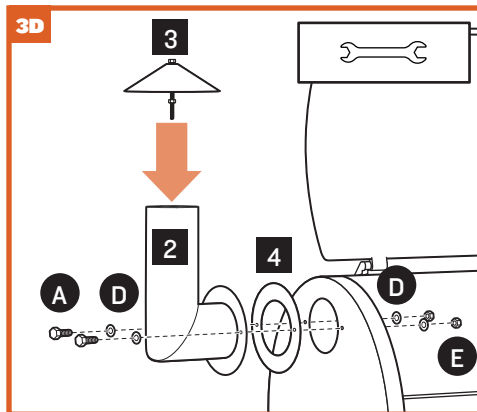

4 PLACE INNER GRILL COMPONENTS AND BUCKET

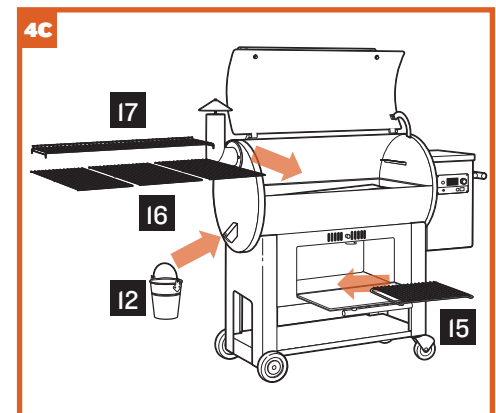
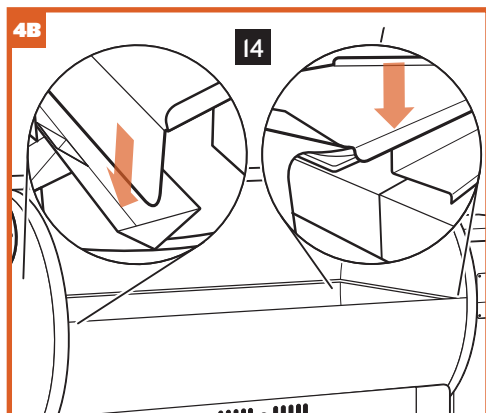
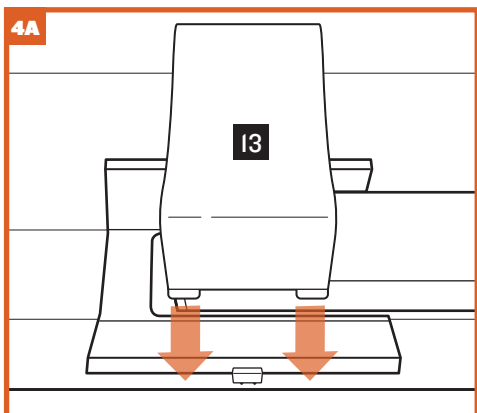

5 YOU ARE READY TO SEASON YOUR GRILL AND GET TRAEGER'ING!

Refer to your Owner's Manual for operating instructions.